

kingston**arts**

kingston**arts**

Technical Specifications

# Shirley Burke Theatre

64 Parkers Road, Parkdale, Vic 3195

March 2024

---

## **Production Team**

[production@kingston.vic.gov.au](mailto:production@kingston.vic.gov.au)

[arts@kingston.vic.gov.au](mailto:arts@kingston.vic.gov.au) | 9556 4440

[www.kingstonarts.com.au](http://www.kingstonarts.com.au)

## Venue Services

### Accessibility

Shirley Burke's public areas are fully accessible. All 3 levels of backstage are fully accessible via lift.

Shirley Burke's Theatre features a hearing loop for people with reduced ranges of hearing.

### Food & Beverage

Shirley Burke Theatre is not licensed and hirers wanting to sell alcohol must arrange their own temporary liquor license. Kingston Arts will consider providing a Candy Bar/Bar service on request.

### Merchandise

Venue Hire must be advised no later than 3 weeks prior to the event if merchandise will be sold. Please discuss requirements with the Venues Hire team.

### Parking And Transport

Parking is limited with alternatives in surrounding streets.

Parkdale Station (Frankston Line) is at the end of Parkers Road, a 100m walk. Bus route 708 (Parkdale Station, Parkers Road)

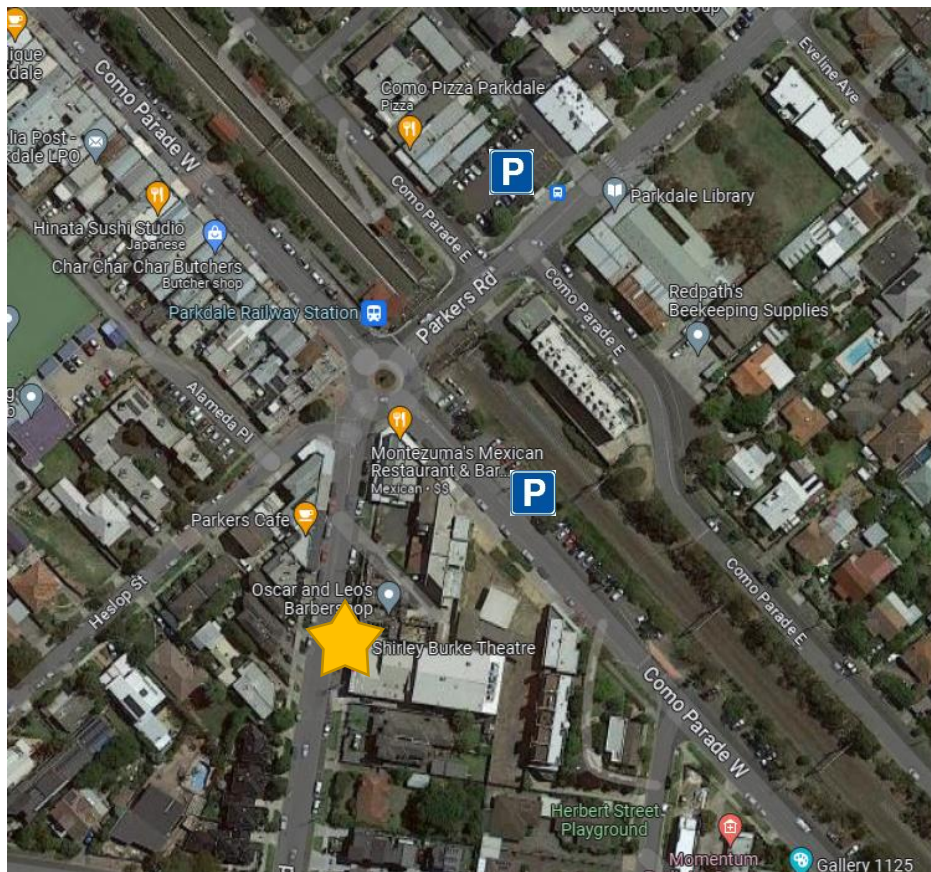

## Stage

See appendix # A

## Auditorium

Venue capacity	167 on main raked auditorium 4 x chairs are removable to accommodate 2 wheelchairs in row A
----------------	--

## Stage

Slightly raked stage. Screwing into surface is not permitted.  
Floor is painted in Reveal Productions Satin Stage Paint (Black)

## Stage Dimensions

Proscenium Width	7200 mm
Proscenium Height	3300 mm
SL to DS edge of apron	370 mm
SL to first LX Bar	800 mm
SL to last LX Bar	6400 mm
SL to rear wall	7600 mm
CL to OP wall (or obstruction)	6500 mm
CL to PS wall (or obstruction)	6500 mm

## Venue Plans

PDF available upon request.

## Flying Facilities

Lines on dedicated LX Bars	4
Hand winch bars over stage	4
Operating Position	Onstage: OP – Behind Proscenium

## Loading Dock

### Access Truck

Truck access is via loading dock off Parkers Road. Small trucks can reverse up to dock door; loading door is parallel to truck.

Access to backstage area is via side roller door Loading Dock Door Dimensions  
3000 mm W x 3000 mm H x 1200 mm (above ground level)

## Restrictions / Obstructions

Trucks must park at a right angle to the loading dock.

Driveway is very narrow and will not accommodate most trucks over 3 ton.

The driveway is used as an emergency exit and therefore must be cleared during all performances.

## Bump Outs

As the driveway is located next to a residential home, any bump outs that will begin or conclude past 11pm Sunday- Thursday or 11:30pm Friday & Saturday, will need to take place via the front of the building. The venue has additional trolleys to assist the process.

We ask that all noise is kept to a minimum when bumping out.

## Drapery

Type	Material	Colour	Width	Height	Qty
House Curtain	Velvet	Dark Purple	8000 mm	4000 mm	1
Proscenium Borders	Velvet	Dark Purple	8000 mm	500 mm	1
Borders	Wool	Black	8000 mm	1500 mm	3
DS Legs	Wool	Black	2000 mm	4000 mm	8
US Blacks	Wool	Black	8000 mm	4000 mm	1
White CYC	Cyclorama	White	8000 mm	4000 mm	2

## Access Equipment

Due to access and loading restrictions, an EWP may not be brought into the venue.

Ladders:

- 1 x 1.8m Fibreglass A frame
- 1 x 2.4m Fibreglass A frame platform

## Portable Staging

There is no portable staging available at Shirley Burke Theatre

## Hanging Plot

SL: Setting Line, *Line Type*: **SP** = Single purchase, **DP** = Double purchase, **MW** = Motor Winch,

**HW** = Hand Winch, **HL** = Handline, *W.L.L.*: Maximum distributed "Working Load Limit" including bar weight

Line #	Distance from SL	Line Type	WLL	Venue Allocation
FOH 1	3200 mm	FIXED	200 kg	FOH 1 (LX)
LX 1	800 mm	HW	200 kg	LX 1
LX 2	2540 mm	HW	200 kg	LX 2
LX 3	4470 mm	HW	200 kg	LX 3
LX 4	6400 mm	HW	200 kg	LX 4

## Lighting

Lighting configuration as per house plan includes:  
Conventional Front, On stage LED Pars, Top Wash

Additional Lighting provided by the venue not on the house plan will incur additional charges. Any changes to the venues standard lighting configuration must be approved by the Coordinator Production minimum of 1 month prior to the commencement of your hire.

Venue's standard rig must be restored at the end of each hire period. Sufficient bump out time should be allowed for this process if the lighting rig is changed. See appendix # B

### Positions

#### Stage LX Bars

4 x LX parts are on hand winches in fixed positions.

#### LX 1

Setting Line to lighting bar

800 mm

Usable bar width

6000 mm

Notes

20 x LX Patch Points, 200KG SWL

#### LX 2

Setting Line to lighting bar

2540 mm

Usable bar width

6000 mm

Notes

20 x LX Patch Points, 200KG SWL

#### LX 3

Setting Line to lighting bar

4470 mm

Usable bar width

6000 mm

Notes

20 x LX Patch Points, 200KG SWL

## LX 4

Setting Line to lighting bar	6400 mm
Usable bar width	6000 mm
Notes	20 x LX Patch Points, 200KG SWL

## FOH Bar 1

Setting Line to lighting bar	3200 mm
Usable bar width	6000 mm
Notes	20 x LX Patch Points, 200KG SWL

## Control

### Lighting desk

LSC Maxim XL with PATPAD section

### Control channels

MAXIM - 48/96 physical faders, with 1024 channels of DMX

### Signal output

DMX / 2 universes

### Signal distribution

Jands DD-8 DMX512 active splitter is available and is part of the venue's standard lighting rig.

- 2 at LX 1
- 2 at LX 2
- 2 at LX 3
- 2 at LX 4
- 1 at FOH LX 1

Remote riggers available onstage

No

## Dimmer Racks

Total Dimmers	48
Dimmer Locations	All Dimmers are located in the dimmer room, DSPS stage

## House Lights

Independent control

House and stair lights are independently controlled via ON/OFF panel.

Control positions

DSPS, control position, Auditorium Door

Fade time adjustable

Fade over 4 seconds, Snap ON/OFF

## Stage Luminaires

### Profiles

Make	Model	Angle	Detail / Accessories	Watt	Total
ETC	Source 4 Junior	25/50	Shutters, Gel Frame	757	04
Selecon	Acclaim Axial	24/44	Shutters, Gel Frame, M Size Gobo Holder	600	16
Selecon	Pacific	45/75	Shutters, Gel Frame, B Size Gobo Holder	1000	04

### Fresnel's

Make	Model	Detail / Accessories	Watt	Total
Selecon	Rama	Barn Doors, Gel Frame	1200	06
Selecon	Acclaim	Barn Doors, Gel Frames	650	21

### Par Cans

Make	Model	Angle	Detail / Accessories	Watt	Total
ProShop Tri Colour Led Par64	LED	25	RGB	20 x 3W	08
Par 56	Par 56	MFL	Gel Frame	300	06

### CYC

Make	Model	Detail / Accessories	Watt	Total
Ehrgeiz	FS-60		20 x 3W	04

## Additional Lighting Equipment\*

Item	Make	Model	Detail / Accessories	Watt	Total
Mirror Ball		500 mm D	Motor		01
Fazer	Antari	Z390 Fazer			01

Note:

\*Charges apply, for more information please contact the Coordinator Production for a copy of our schedule of fees.

## Patching

Location	Quantity	Numbering	Detail / Accessories
FOH 1	20	A 1 - 20	1 x DMX 5 Pin
LX 1	20	B 1 - 20	2 x DMX 5 Pin
LX 2	17	B21 - 41	2 x DMX 5 Pin
LX 3	17	C 1 - 20	2 x DMX 5 Pin
LX 4	17	C21 - 41	2 X DMX 5 Pin
US PS	03		Floor LX, requires round earth pin adaptor
US OP	03		– Venue has stock

## Power

6 x 32amp on stage level – Dimmer Cupboard 4 in use by standard dimmers

## Cabling

### 240v Extension Cable

The venue has a good stock of extension leads to accommodate the venues own requirements, with limited additional cable.

### 240v Looms

The venue has no 240v looms available. These must be hired at the hirer's expense if required.

### 3 phase Extensions

The venue has no 3 phase extensions available. These must be hired at the hirer's expense if required.



## Audio

Standard hire includes:

Audio console, FOH speaker system, 2 x cabled microphones, 4 x wireless Channels (receivers only).

Any changes to the standard house configuration must be approved by the Coordinator Production a minimum of 1 month prior to the commencement of your hire and may incur additional charges.

## Control Positions

Auditorium	Bio Box, Rear of auditorium, centered, raised. No seats pulled
Other	Production desk, Rear of Auditorium, centered, raised, 7 seats pulled

Primary Mixer	
Allen and Heath SQ6	48 channels, 12 stereo mixes (Aux/ group), 3 stereo matrixes, 8 stereo FX

## Theatre FOH:

2 x EV EKX-12P 1500W Powered Speakers

## Foldback

Type	Qty
RCF ART 315A 350W Bi-Amp Powered speakers	02
RCF ART 312A 400W Bi-Amp Powered speakers	04
RCF ART 310A 350W Bi-Amp Powered speakers	04

## Subwoofers:

2 x EV EKX-18SP 1300W Powered Sub Woofers

# kingstonarts

## Playback

Item	Make	Model	Detail	Total
CD Player	Numark	MP103	CD + USB input playback	01

## Microphones

Make	Model	Detail / Accessories	Use	Total
JAG	IMX6A	For Wireless	Headsets/Vocals	04
Shure	SM58	Clip	Vocal	06
Shure	SM57	Clip	Instrument/Vocal	06
Shure	MX202	Hanging Condenser Microphone	Choir/general coverage	02
Shure	MX412	Gooseneck Condenser Microphone	Lectern Microphone	02
Sennheiser	E935	Dynamic Microphone Clip	Vocal	02
Shure	PG Drums	6 mic Drums set	Kick/snare/toms/overhead	01
Behringer	DI-100	Active DI Box	Direct Injection	06
Art	Z Direct	Passive DI Box	Direct Injection	02

## Wireless Microphones and Systems

Make	Model	Detail / Accessories	Use	Total
Shure	Beta 58A SLX	Handheld Microphone	Vocal	04
Shure	SLX1	Bodypack		04
Shure	SLXD2	Handheld Microphone	Vocal	04

## Accessories

Make	Model	Total
K&M	Tall Telescopic Boom stand	
K&M	Tall Round Base	
K&M	Short Telescopic Boom stand	
Generic	Desktop Short Stand Round Base	
Generic	Speaker Stands – Push Up	

## Line Patching

Location	Quantity	Numbering	Detail
DSPS	12	12 in, 2 out	
DSOP	12	12 in, 2 out	
DSPS Trap	8	6 in, 2 out	
DSOP Trap	8	6 in, 2 out	
LX 3	2	MX202 PS/OP	2 lines run to LX 3 for MX202 hanging microphone.

## Cabling

### Audio Cable

The venue has a good stock of cable to accommodate its in-house equipment.

### Multicore

1 x AR2412 Audio Rack for Allen and Heath SQ6 console, 24in, 12 out

### Note:

FOH L & R speakers are rigged in fixed positions.

## Audio Visual

### Projectors

Type	Model	Detail / Accessories	Total
Epson Lamped Projector	EB-G7500	6500 Lumens	01

### Projection Screens

Projection is on the tensioned CYC cloth at the front of stage.

### AV Playback Equipment

Item	Model	Detail / Accessories	Total
Blu-Ray Player	Panasonic	DMP-BDT220	01

### Projector Rigging Points

Standard rigging is from the top of the bio box.

## Cabling

The Venue has a sufficient stock of cable to accommodate projection from the standard position.

Note: All A/V patching throughout the venue is Cat 5e UTP cable.

- 2 Lines from Bio Box to FOH Bridge

- 1 Line from Bio to DSPS

- 1 Line from Bio to DSOP

- 2 Lines from Bio to Studio

## Backstage

### Communications

#### *Talkback*

Master Unit	Jands EziComm E-401 Master Station. (4 ring)
Total sub stations	3
Total headsets	3
Talkback patching located at:	Bio Box

#### Paging / Show relay

A show relay is provided in the dressing room and box office.

#### Stage Monitor

Stage monitor has IR capabilities.

Television monitors showing the stage are standard in the following areas:

PS (SL) SM Desk, Dressing Room (With Audio), Bio Box, Box Office (With Audio), Studio (With Audio)

#### Q Light System

There is no in-house Q lighting system.

## Dressing Rooms

Dressing Room	Capacity	Toilets	Shower	Details
Room	6-8	2	Yes	1 Disabled toilet, 1 unisex toilet

## Laundry / Wardrobe

Washing Machines	1
Dryers	1
Drying rooms	NO
Iron / ironing board	1
Clothes racks	4

## Production Facilities

Production Office	NO
Internet access	YES

## Greenroom

Tea / Coffee facilities	At Hirer's Expense
Fridge / freezer	YES
Microwave	NO
Running water	NO

## Additional Included Stage Furniture

Lectern

Chairs

Trestle Tables

## Appendix A – Shirley Burke Theatre Stage Plan

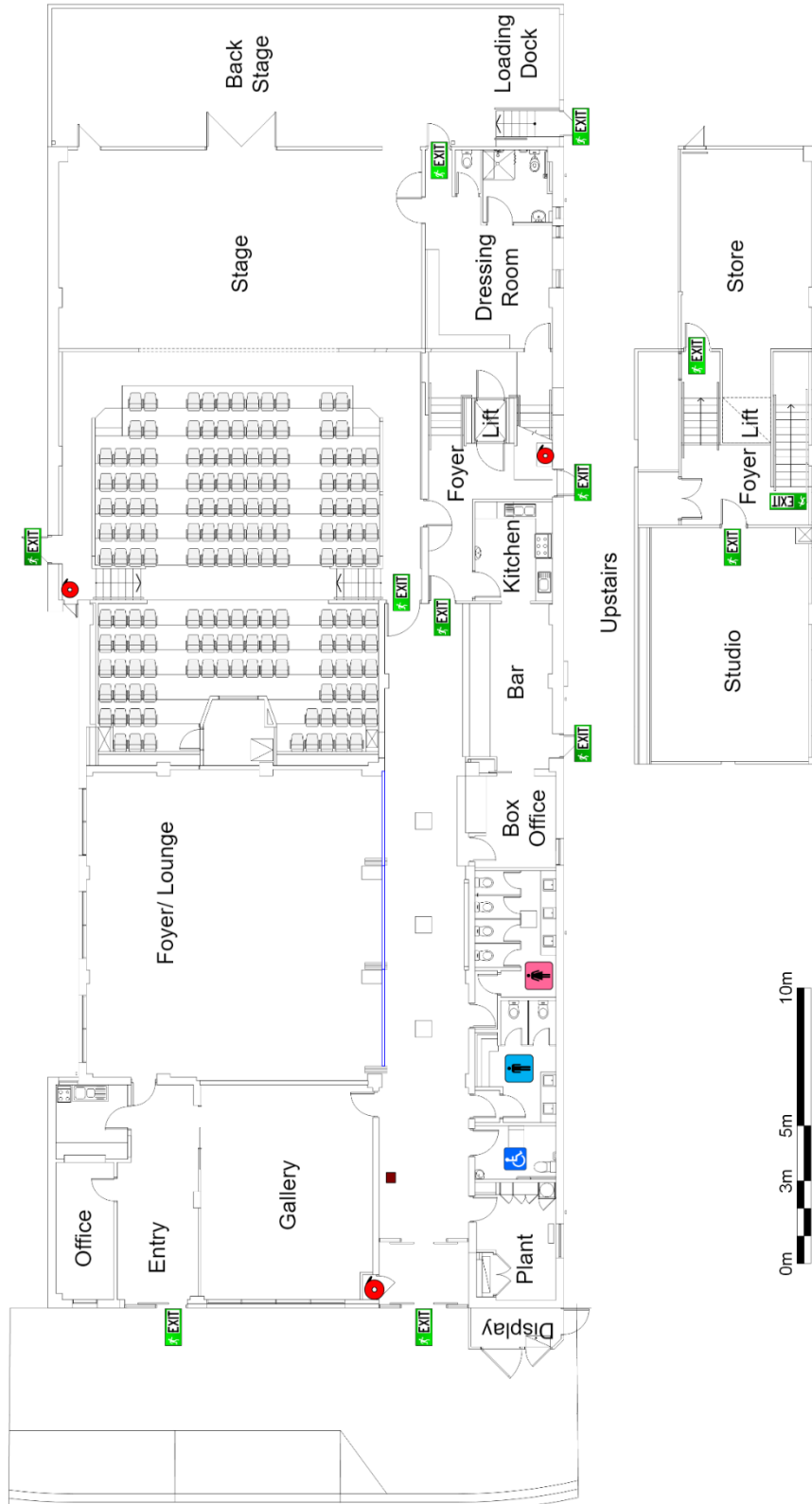

## Appendix B – Shirley Burke Theatre Lighting Plan

